

INTEGRAL SIDESHIFTER LOCK-OUT KIT INSTALLATION INSTRUCTIONS 252662

7040 South Highway 11 • Westminster, SC 29693 • Toll Free (888) 946-3330 • (864) 647-1119 • FAX (864) 647-6195

The following instructions show how to install the LTI Integral Sideshifter Lock-Out Kit for use of the LTI ISS with a hang-on attachment.

Note: The use of rotating attachments on an LTI ISS is not approved by Lift Technologies.

The Lock-Out Kit includes two adjustable sleeves as shown below:

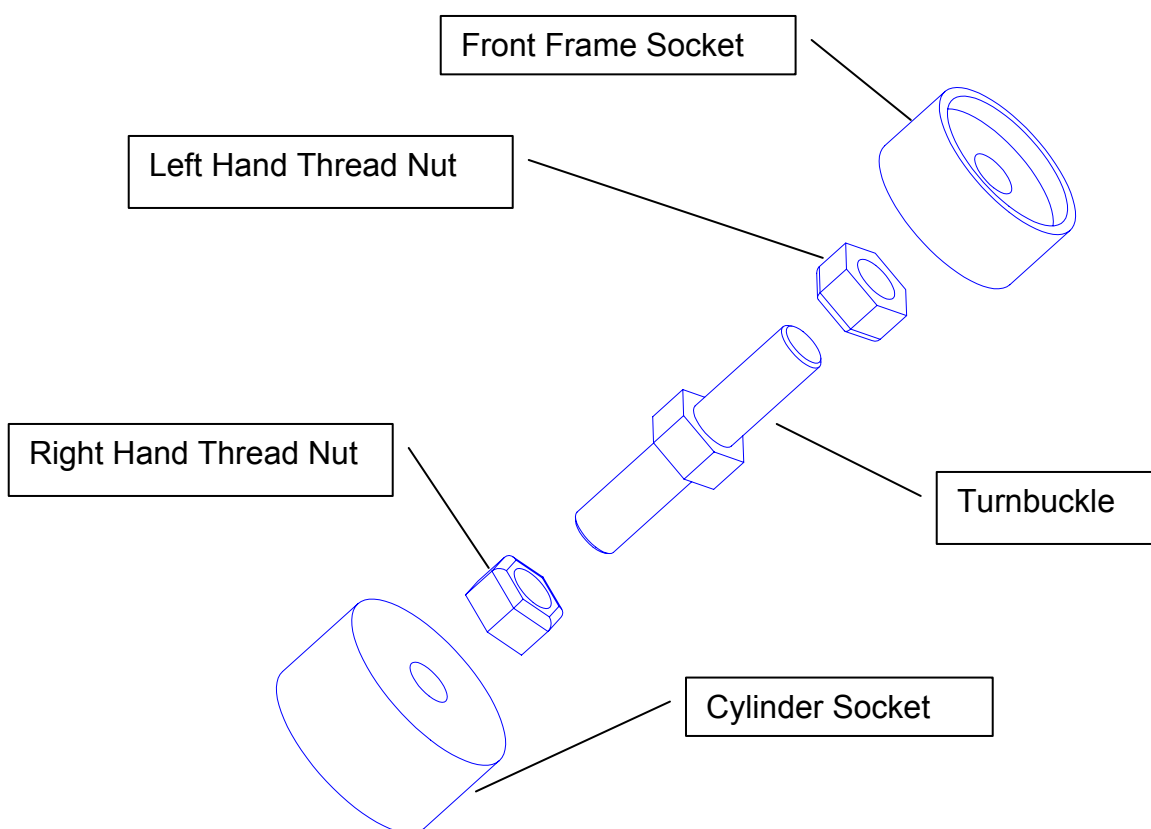

INTEGRAL SIDESHIFTER LOCK-OUT KIT INSTALLATION INSTRUCTIONS 252662

7040 South Highway 11 • Westminster, SC 29693 • Toll Free (888) 946-3330 • (864) 647-1119 • FAX (864) 647-6195

Procedure for Installing ISS Lock-Out Kit (Truck key should be removed during installation of ISS Lock-Out kit to prevent unintended operation of ISS):

- Option 1: If truck hydraulics permit, hold sideshift lever on truck open while another person pushes the front frame back and forth. This movement will allow the pressure inside the cylinder block to be relieved, and allow the rods to be pushed fully inside the cylinder block. Rods must be fully retracted in order to install lock-out.
- Option 2: If truck hydraulics prevents option 1, remove hoses connected to fittings in termination bracket. Hold loose hoses over approved hydraulic fluid container, and push the front frame back and forth. This movement will allow the pressure inside the cylinder block to be relieved, and allow the rods to be pushed fully inside the cylinder block. Rods must be fully retracted in order to install lock-out. Retighten hoses. If hoses have been removed insure all fittings have caps installed to prevent contamination.

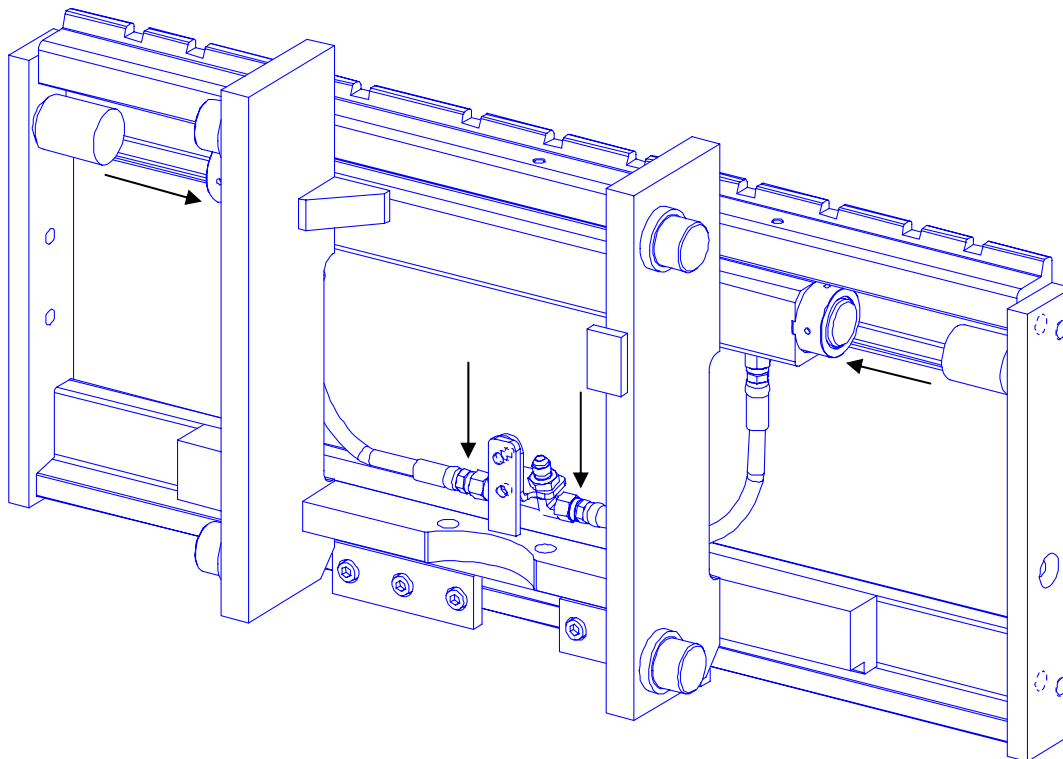

INTEGRAL SIDESHIFTER LOCK-OUT KIT INSTALLATION INSTRUCTIONS 252662

7040 South Highway 11 • Westminster, SC 29693 • Toll Free (888) 946-3330 • (864) 647-1119 • FAX (864) 647-6195

- Insure front frame is centered on spine.
- Install one lock-out on each side of unit.
- Tighten into place and torque nuts to 50-70 ft-lbs.
- Recheck torque every 40-50 hours.

